

Nr.	Omschrijving	Artikelnummer	Nr.	Omschrijving	Artikelnummer
1	SET POTEN	XSPC80008000			
2	SCHROEVEN/MOERENSET TBV FRAME	XSPC84007000			
3	VERSTEBAK 45° S-COUP	BEGA010000			
4	WATERBAK	XSPC80001000			
5	SET RAILHOUDERS	XSPC90011000			
6	HANDGREEP COMPL.	XSPC90119000			
7	ZAAGWAGENBLOKKERING COMPL.	XSPC90118000			
8	SET WIELEN TBV ZAAGWA- GEN	XSPC80015000			
9	SET RAILS	XSPC90035000			
10	WATERPOMP TYPE P-0 COM- PL.	XWPE010000			
11	CENTIMETERVERDELING ZAAGWAGEN	XSPC90050000			
12	VARIABELE MATERIAALAAN- SLAG COMP	XSPC90107000			
13	SET ZELFKLEVENDE RUBBER MATTEN	XSPC37506-10			
14	MOEREN/SCHROEVEN TBV ZAAGKOP	XSPC80024000			
15	SET VOOR HOOGTE-INSTEL- LING COMPL	XSPC80012000			
16	SET SPATLAPPEN	XSPC90043000			
17	HOUDER GROTE SPATLAP	XSPC90320000			
18	ZAAGWAGEN COMPL.	XSPC80034000			
19	WATERSLANG	XSPC07071R00			
20	WATERSTOP COMPL.	XSPC84025000			
21	ARM TBV ZAAGKOP	XSPC80002000			
21	ARM TBV ZAAGKOP RAL 3020	XSPC8000200R			
22	WIELSET	XSPC80013000			
23	GEREEDSCHAPSET COMPL.	XSPC03032000			

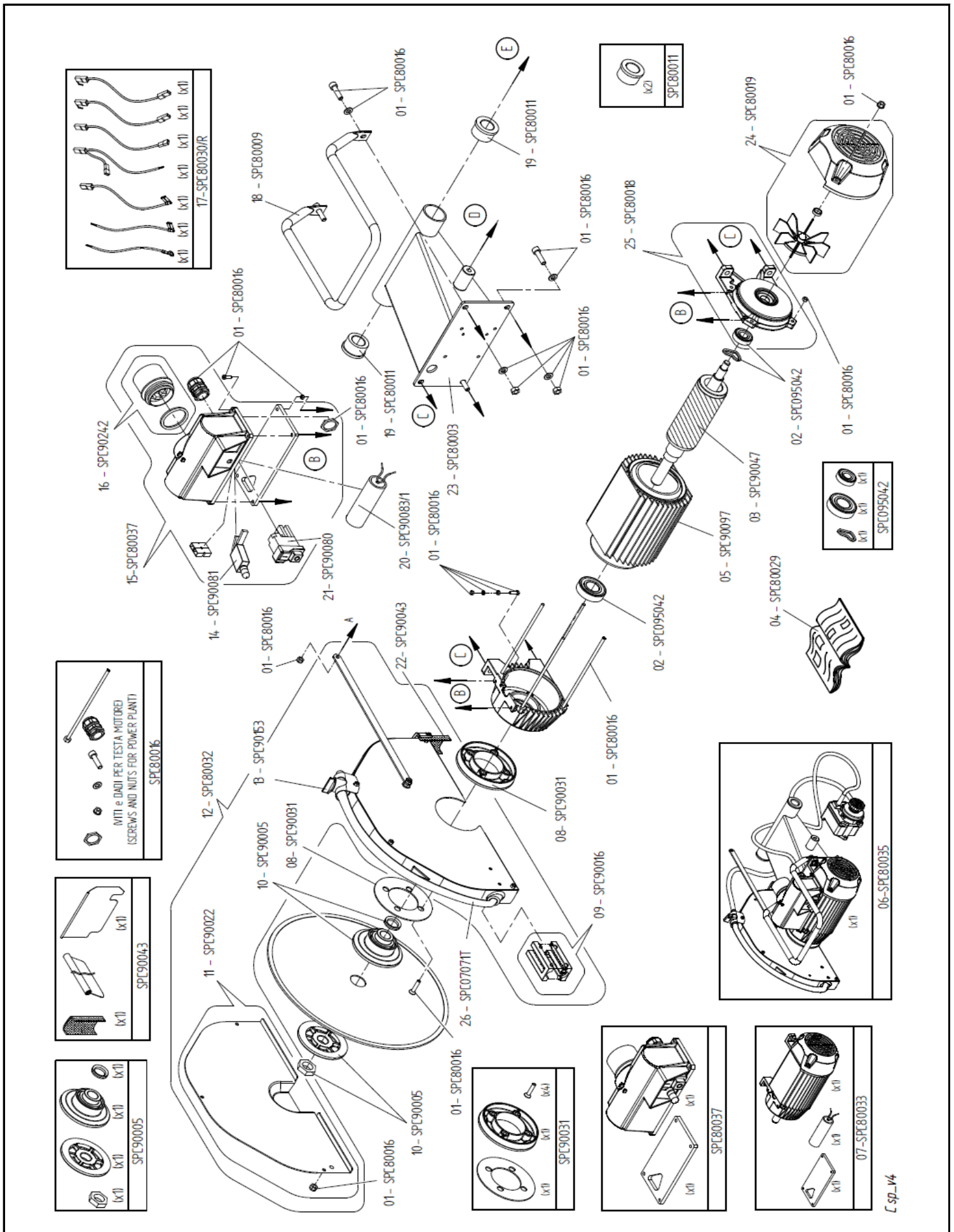

Nr.	Omschrijving	Artikelnummer	Nr.	Omschrijving	Artikelnummer
1	SCHROEVEN/MOERENSET MOTOR	XSPC80016000			
2	LAGER/RINGENSET TBV MOTOR	XSPC09504200			
3	ANKER	XSPC90047000			
4	HANDLEIDING	XSPC80029000			
5	VELD COMPL. 230V	XSPC90097000			
6	ZAAGKOP COMPL. 230V	XSPC80035000			
7	MOTOR COMPL. 230V	XSPC80033000			
8	SET RINGEN TBV ZAAGKAP	XSPC90031000			
9	SPROEIVORK COMPL.	XSPC90016000			
10	FLENZENSET COMPL.	XSPC90005000			
11	PLAAT ZAAGKAP COMPL. Ø350MM	XSPC90022000			
12	ZAAGKAP COMPL. Ø350MM	XSPC80032000			
13	WATERKRAAN COMPL.	XSPC90153000			
14	THERMISCHE VEILIGHEID	XSPC90081000			
15	AANSLUITDOOS COMPL.	XSPC80037000			
16	OPBOUWSTEKKER COMPL. 230V	XSPC90242000			
17	KABELSET	XSPC80030-R0			
18	HANDGREEP	XSPC80009000			
19	SET NYLON GLIJRINGEN	XSPC80011000			
20	CONDENSATOR 40Mf.	XSPC90083-10			
21	SCHAKELAAR	XSPC90080000			
22	SET SPATLAPPEN	XSPC90043000			
23	MOTORMONTAGEPLAAT	XSPC80003000			
24	VENTILATOR + KAP	XSPC80019000			
25	AFDEKKAP TBV VELD COMPL.	XSPC80018000			
26	WATERSLANG	XSPC07071T00			